

# EAO – Your Expert Partner for Human Machine Interfaces

## 22-353.111D - Keylock switch 2 positions

### 22-353.111D - Keylock switch 2 positions

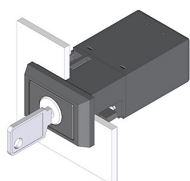

*Attention: The preview is based on a sample product. This can differ from your current configuration.*

#### Mounting

Mounting cut-out  
Design 22 mm x 30 mm  
flush

#### Front

Front dimension 24 mm x 36 mm  
Front shape rectangular

#### Other Attributes

Weight 0,051 kg

#### Operating-/Indication part

Switching angle 45° right

#### IP-Rating

Front protection IP65

#### Connection Method

Terminal Screw terminal

#### Actuator

Switching action Rest(a) - Momentary

#### Switching element

Rotary positions 2  
Switching system Snap-action switching element  
Switching voltage 400 V AC  
Switching current 10 A  
Contacts 2 NO  
Contact material Silver

#### Function

Keylock switch

# EAO – Your Expert Partner for Human Machine Interfaces

## 22-353.111D - Keylock switch 2 positions

### Dimensions

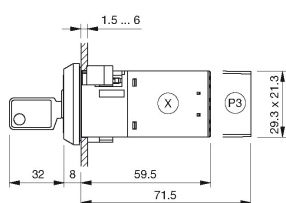

X = Screw terminal

### Mounting cut-outs

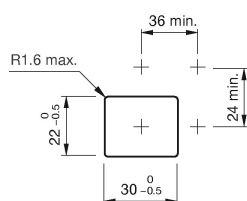

### Wiring diagram



### Switching positions

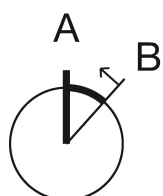

### Additional information

Standard lock: DOM 311

Two keys are supplied with each key lock switch

Optional lock numbers on request

### Legend

Contacts: NO = Normally open

Switching action: B = Momentary