

EAO – Your Expert Partner for Human Machine Interfaces

752-.401-0P - Keylock switch actuator 3 positions square

752-.401-0P - Keylock switch actuator 3 positions square



Attention: The preview is based on a sample product. This can differ from your current configuration.

Mounting

Mounting cut-out	21 mm x 21 mm
Design	flush

Front

Front dimension	24 mm x 24 mm
Front shape	square

Other Attributes

Weight	0,023 kg
--------	----------

Operating-/Indication part

Switching angle	
-----------------	--

IP-Rating

Front protection	IP40
------------------	------

Connection Method

Terminal	PCB
----------	-----

Actuator

Switching action	Momentary - Rest(a) - Maintain(a)
------------------	-----------------------------------

Switching element

Rotary positions	3
Switching system	Snap-action switching element
Contacts	2 NC + 2 NO
Switching current	5 A
Contact material	
Switching voltage	250 V AC

Function

Keylock switch	
----------------	--

EAO – Your Expert Partner for Human Machine Interfaces

752-.401-0P - Keylock switch actuator 3 positions square

Dimensions

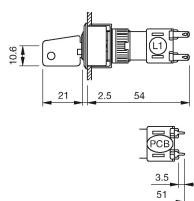

Mounting cut-outs

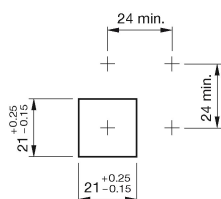

Wiring diagram

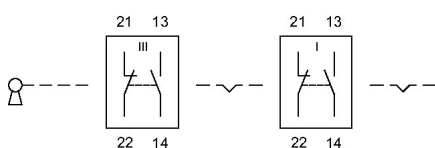

Component layout

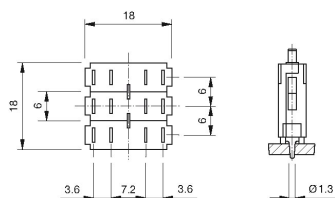

Additional information

Standard lock B2 300

Further lock numbers see «Technical data»

Legend

Contacts: NC = Normally closed, NO = Normally open

Switching action: A = Rest, B = Momentary, C = Maintained

EAO – Your Expert Partner for **Human Machine Interfaces**

752-.401-0P - Keylock switch actuator 3 positions square

Switching positions

