

# EAO – Your Expert Partner for Human Machine Interfaces

## 44-800.2 - Lever switch complete

### 44-800.2 - Lever switch complete



*Attention: The preview is based on a sample product. This can differ from your current configuration.*

#### Mounting

|                  |           |
|------------------|-----------|
| Mounting cut-out | Ø 22,3 mm |
| Design           | raised    |

#### Front

|                 |         |
|-----------------|---------|
| Front shape     | round   |
| Front dimension | Ø 22 mm |

#### Other Attributes

|        |          |
|--------|----------|
| Weight | 0,080 kg |
|--------|----------|

#### Operating-/Indication part

|                |         |
|----------------|---------|
| Lever colour   | black   |
| Lever material | Plastic |

#### IP-Rating

|                  |      |
|------------------|------|
| Front protection | IP65 |
|------------------|------|

#### Connection Method

|          |                     |
|----------|---------------------|
| Terminal | Solder 2.8 x 0.5 mm |
|----------|---------------------|

#### Actuator

|                  |           |
|------------------|-----------|
| Switching action | Momentary |
|------------------|-----------|

#### Switching element

|                   |                               |
|-------------------|-------------------------------|
| Switching voltage | 250 V AC                      |
| Switching current | 5 A                           |
| Contacts          | 2 NC + 2 NO                   |
| Switching system  | Snap-action switching element |
| Contact material  |                               |

#### Function

|              |  |
|--------------|--|
| Lever switch |  |
|--------------|--|

# EAO – Your Expert Partner for Human Machine Interfaces

## 44-800.2 - Lever switch complete

### Dimensions

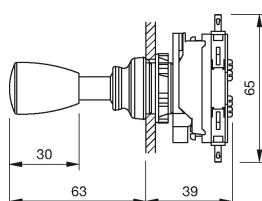

### Mounting cut-outs

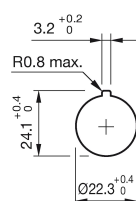

### Wiring diagram

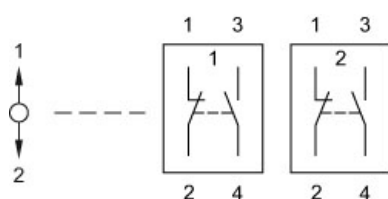

### Component layout

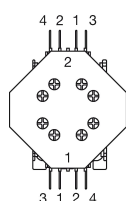

### Additional information

2 positions (L-R)

With flat receptacle, VDE 0630 (SEV) specify use of insulating sleeve Part No. 280-0010-00

### Legend

Contacts: NC = Normally closed, NO = Normally open

Switching action: B = Momentary