

## SUMMARY

### # Wires

Low voltage 26



*Image is for illustrative purpose only*

Series 3B  
Termination type Coupler/adapter/bridge  
IP rating 50  
AWG wire size 22.00 - 22.00  
Cable Ø 0.00 - 0.00 mm  
Status active

### Download

[Request a quote](#)

[Catalog](#)

## TECHNICAL DETAILS

### Mechanics

Shell Style/Model RBL\*: Fixed coupler, nut fixing, keys (B) at the flange end and keys (L) at the other end  
Keying Front side: 2 keys (alpha=45, female) ; Other side: 2 keys (gamma=70, male)  
Housing Material Brass (chrome plated) shell and collet nut, nickel plated brass latch sleeve and mid pieces  
Weight 81.32 g

### Performance

Configuration 3B.326 : 26 Low Voltage  
Insulator L: PEEK (UL 94 / V-0/1.5)  
Rated Current 4 Amps

### Specifications

Contact Type: Solder  
Contact Dia.: 0.7 mm (0.03in)  
V<sub>test</sub> (contact-shell): 700 V (AC), 990 V (DC)  
V<sub>test</sub> (contact-contact): 950 V (AC), 1340 V (DC)  
□

### Others

Endurance (Shell): 5000

*LEMO products and services are provided "as is". LEMO makes no warranties or representations with regard to LEMO product & services or use of them, express, implied or statutory, including for accuracy, completeness, or security. The user is fully responsible for his products and applications using LEMO components.*

Temp (min / max): -55° C / +250° C  
 Humidity (max): <=95% [at 60 deg C /140 F]  
 Vibration: 15 g [10 Hz - 2000 Hz]  
 Shock Resistance: 100 g [ 6 ms]  
 Climatical Category: 50/175/21  
 Shielding (min): 75 dB (10 MHz)  
 Shielding (min): 40 dB (1 GHz)  
 Salt Spray Corrosion: >1000 hr

## DRAWINGS

Draws

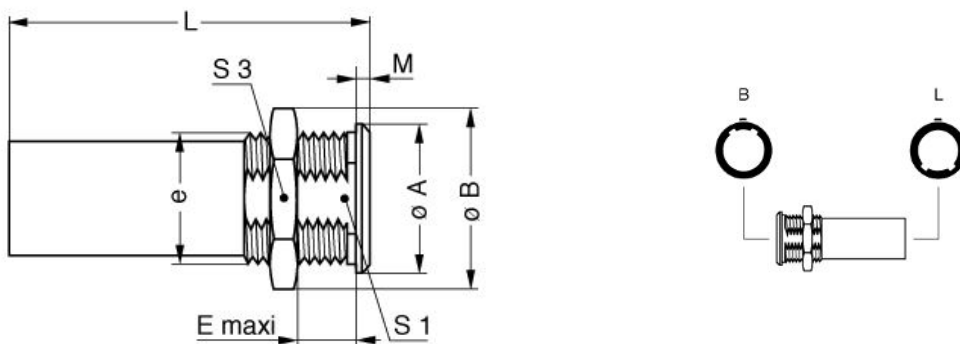

Dimensions

	A	B	E	L	M	S1	S3	e
mm.	25	27.5	32	53	4	18.5	24	M20x1.00
in.	0.98	1.08	1.26	2.09	0.16	0.73	0.94	

## RECOMMENDED BY LEMO

Tools

Cables

*LEMO products and services are provided "as is". LEMO makes no warranties or representations with regard to LEMO product & services or use of them, express, implied or statutory, including for accuracy, completeness, or security. The user is fully responsible for his products and applications using LEMO components.*